

GE

Energy Connections

Model 3P42

Current Transformer Window Diameter 2.50"

Application

3 phase relay, metering and motor overload protection.

Frequency

50-400 Hz.

Insulation Level

600 Volts, 10 kV BIL full wave.

Terminals are brass studs No. 8-32 with one flatwasher, lockwasher and regular nut.

Approximate weight 11.5 lbs.



Data Table: Model 3P42

Catalog Number	Current Ratio	Relay Class	ANSI Metering Class at 60 Hz					Secondary Winding Resistance (Ω @ 75 °C)
			BO.1	BO.2	BO.5	BO.9	B1.8	
3P42-101	100:5	—	1.2	2.4	—	—	—	0.035
3P42-151	150:5	—	0.6	1.2	—	—	—	0.053
3P42-201	200:5	—	0.6	0.6	1.2	—	—	0.071
3P42-251	250:5	—	0.3	0.3	1.2	—	—	0.088
3P42-301	300:5	—	0.3	0.3	0.6	1.2	2.4	0.106
3P42-401	400:5	C10	0.3	0.3	0.6	0.6	1.2	0.112
3P42-501	500:5	C10	0.3	0.3	0.3	0.6	1.2	0.140
3P42-601	600:5	C10	0.3	0.3	0.3	0.6	0.6	0.168
3P42-751	750:5	C20	0.3	0.3	0.3	0.6	0.6	0.265
3P42-801	800:5	C20	0.3	0.3	0.3	0.3	0.3	0.283
3P42-102	1,000:5	C10	0.3	0.3	0.3	0.3	0.3	0.308
3P42-122	1,200:5	C10	0.3	0.3	0.3	0.3	0.3	0.365
3P42-152	1,500:5	C10	0.3	0.3	0.3	0.3	0.3	0.462
3P42-162	1,600:5	C10	0.3	0.3	0.3	0.3	0.3	0.492



Model 3P42

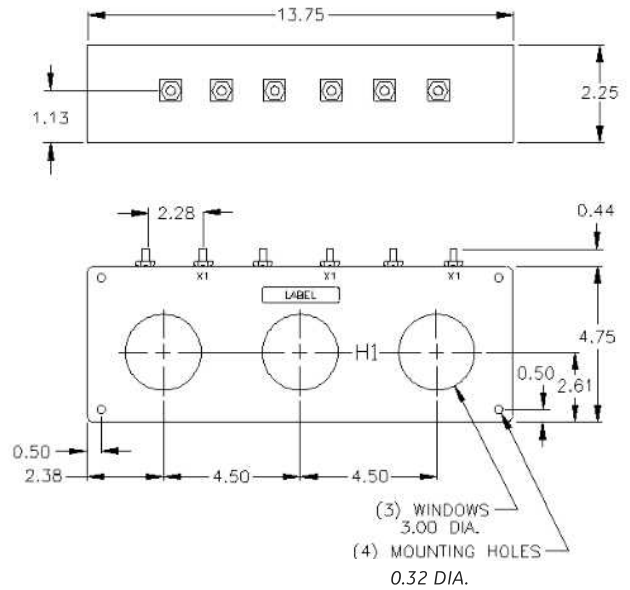
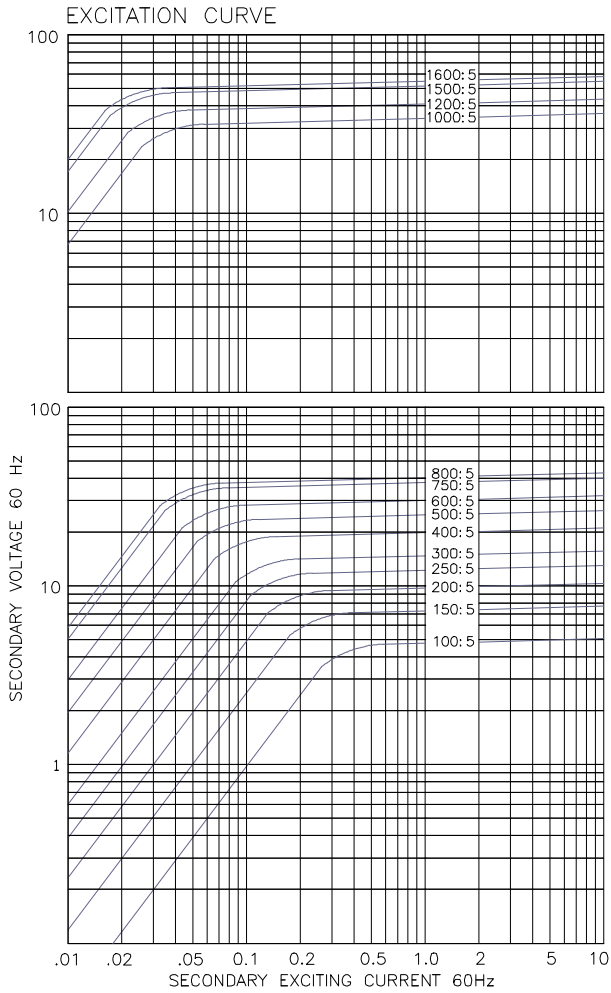

GEGridSolutions.com

Grid-AIS-L4-ITL_Model_3P42-1194-2017_05-EN. © Copyright 2017. General Electric Company and Instrument Transformers LLC reserve the right to change specifications of described products at any time without notice and without obligation to notify any person of such changes.

Worldwide Contact Center

Web: www.GEGridSolutions.com/contact

Phone: +44 (0) 1785 250 070

USA and Canada: +1 (0) 800 547 8629

Europe, Middle East and Africa: +34 (0) 94 485 88 00

